



Overview SJ High-speed train

X2000:

Southbound trains – carriage 1 is at the front and carriage 7 is at the back. Northbound trains – carriage 7 is at the front and carriage 1 is at the back.

Trains to Jönköping, arriving from Stockholm (or opposite direction), change direction in Nässjö. If you travel facing forwards from Stockholm/Jönköping, you will travel facing backwards for the remainder of your journey after Nässjö. If you travel facing backwards from Stockholm/Jönköping, you will travel facing forwards for the remainder of your journey after Nässjö.

Trains to Strömstad, arriving from Stockholm (or opposite direction), change direction in Herrljunga. If you travel facing forwards from Stockholm/Strömstad, you will travel facing backwards for the remainder of your journey after Herrljunga. If you travel facing backwards from Stockholm/Strömstad, you will travel facing forwards for the remainder of your journey after Herrljunga.

Carriages 1 and 2 1st Class | 48 seats | There may be guide and service dogs by the disabled seats.

← Engine

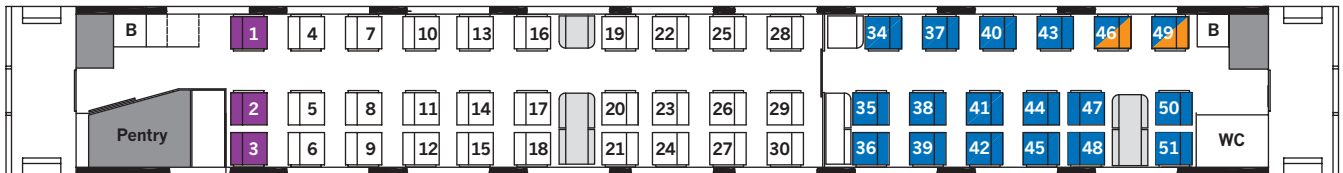

Non-animal zone: carriage 1 seats 1 – 3 **Disabled seat (no wheelchairs):** carriage 1 seats 44, 45, 46 and 49

Quiet zone: carriage 2 seats 34 – 51

Carriages 3, 4 and 6 2nd Class | 72 seats.

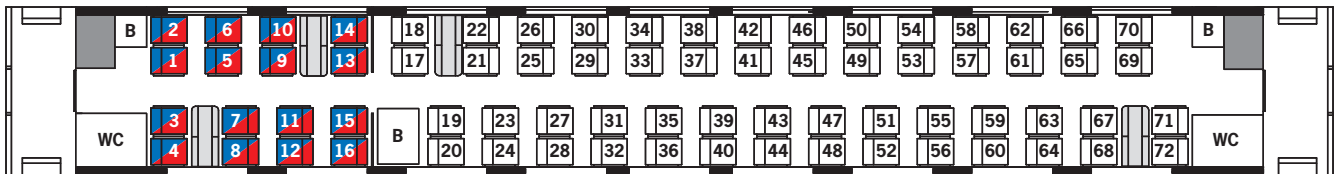

Quiet zone: carriage 4 seats 1 – 16 **Non-animal zone:** carriage 4 seats 65 – 66, 69 – 70 **Animals permitted:** carriage 6 seats 1 – 16

Carriage 5 2nd Class | 28 seats – bistro, 18 seats.



Carriage 7 2nd Class | 41 seats + 2 wheelchair places | There may be guide and service dogs by the disabled seats.

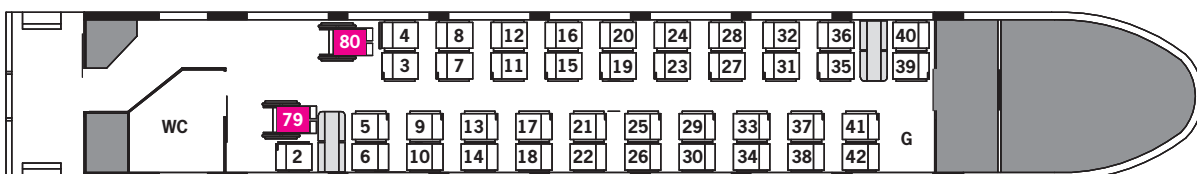

Wheelchair place: 80 **Wheelchair place with seat:** 2/79 **Disabled seat (no wheelchair):** 3 – 4, 7 – 8, 11 – 14

Seat close to wheelchair space: 5 – 6, 9 – 10



Overview SJ 3000

Southbound trains operate with carriage 1 at the front and carriage 4 at the back. Northbound trains operate with carriage 4 at the front and carriage 1 at the back. The reverse applies on trains on the Göteborg – Malmö – Göteborg route, i.e. trains bound for Malmö operate with carriage 4 at the front and carriage 1 at the back while trains bound for Göteborg operate with carriage 1 at the front and carriage 4 at the back.

On Stockholm – Karlstad – Stockholm route applies the following: trains bound for Karlstad operate with carriage 1 at the front and carriage 4 at the back and trains bound for Stockholm operate with carriage 4 at the front and carriage 1 at the back.

Trains to Uddevalla, arriving from Stockholm (or opposite direction), change direction in Herrljunga. If you travel, facing forwards from Stockholm/Uddevalla, you will travel facing backwards for the remainder of your journey after Herrljunga. If you travel facing backwards from Stockholm/Uddevalla, you will travel facing forwards for the remainder of your journey after Herrljunga.

Carriage 1 1st Class

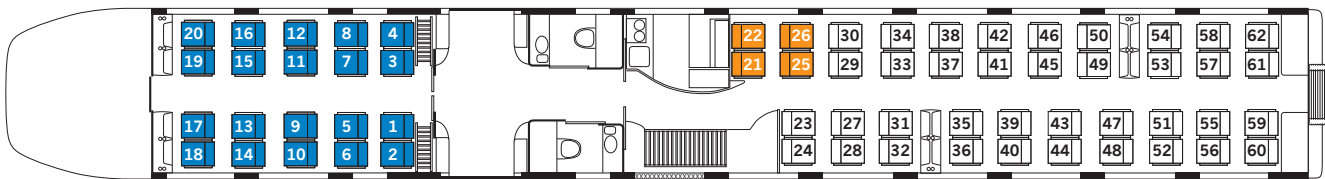

Disabled seat: 21, 22, 25 and 26 Quiet zone: 1 – 20

Carriage 2 2nd Class

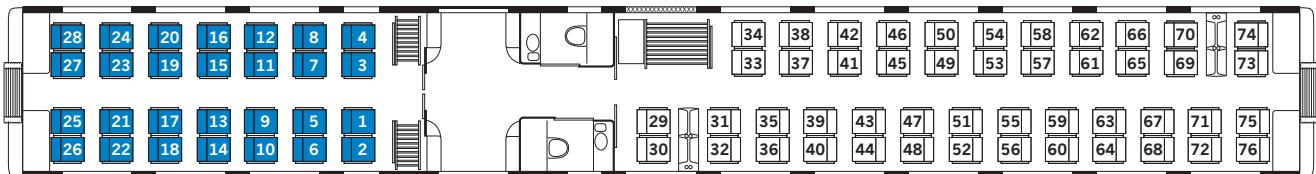

Quiet zone: 1–28

Carriage 3 2nd Class

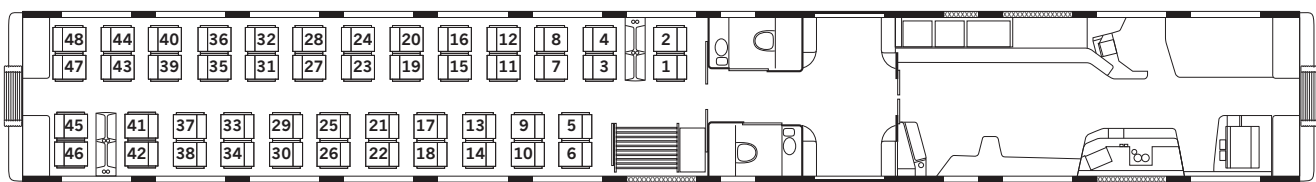

Bistro

Carriage 4 2nd Class

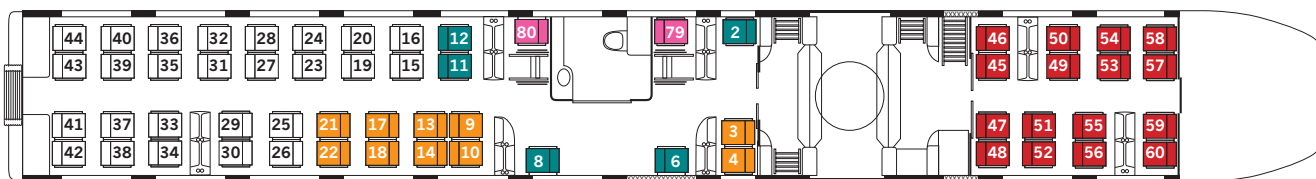

Wheelchair place: 79 and 80 Seat close to wheelchair space: 2, 6, 8, 11 and 12 Disabled seat: 3, 4, 9, 10, 13, 14, 17, 18, 21 and 22 Animals permitted: seats 45-60

